

WORLD WAR II MEMORIAL

City of Myrtle Beach, South Carolina

September 20, 2022



PROPOSED PARKING LOT

PROPOSED RESTROOM

WARBIRD PARK

FARROW PKWY

HORZ. SCALE 0 30 60 FEET

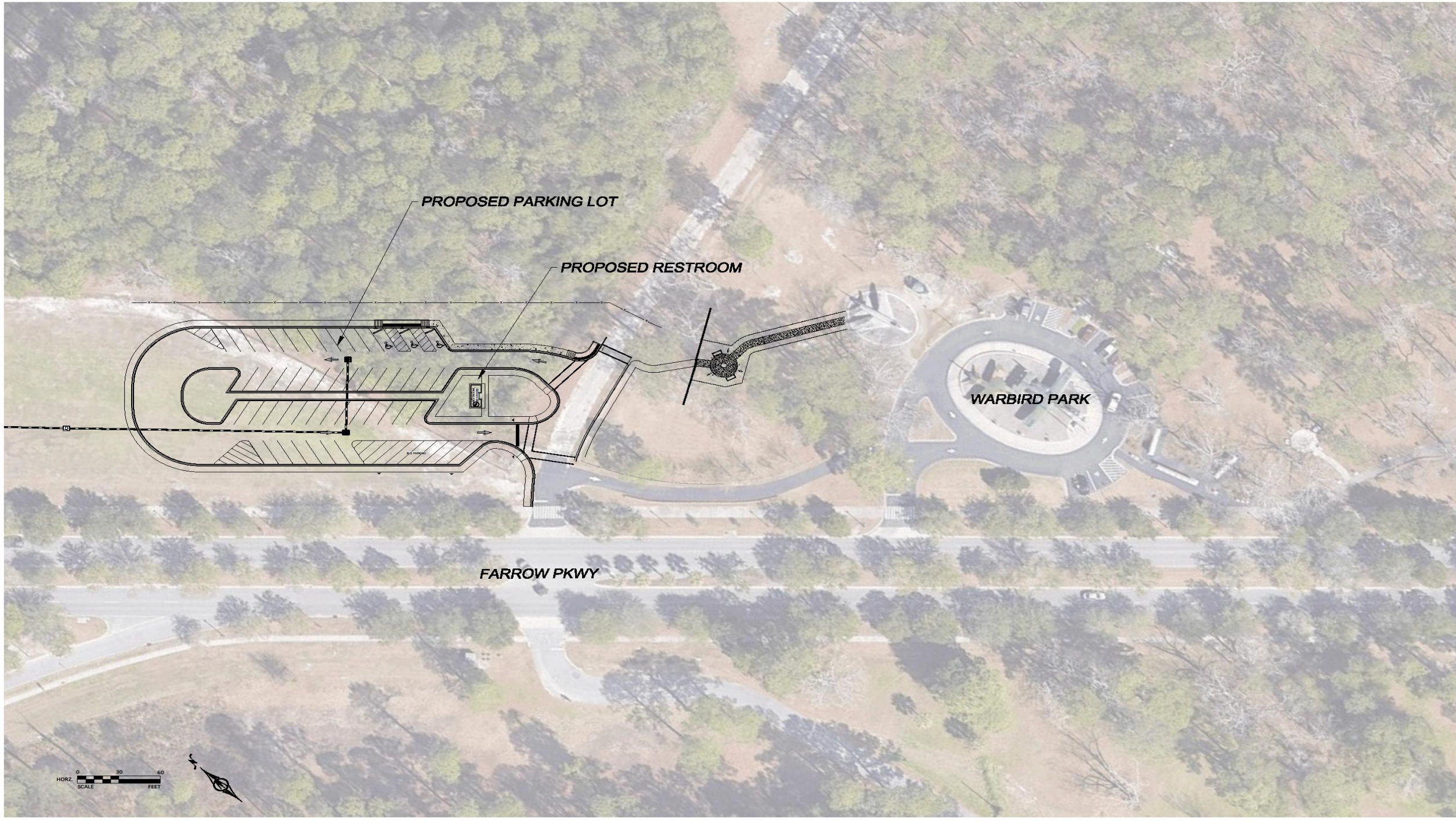



- Stone benches with engraved military branch's motto
- Light columns for each military branch
- Sculpture node with inspirational quote on wall
- Memorial wall with engraved images of Myrtle Beach military history
- Decorative plaza space with map of the world
- American flag with memorial base
- Plaza entrance with overhead trellis



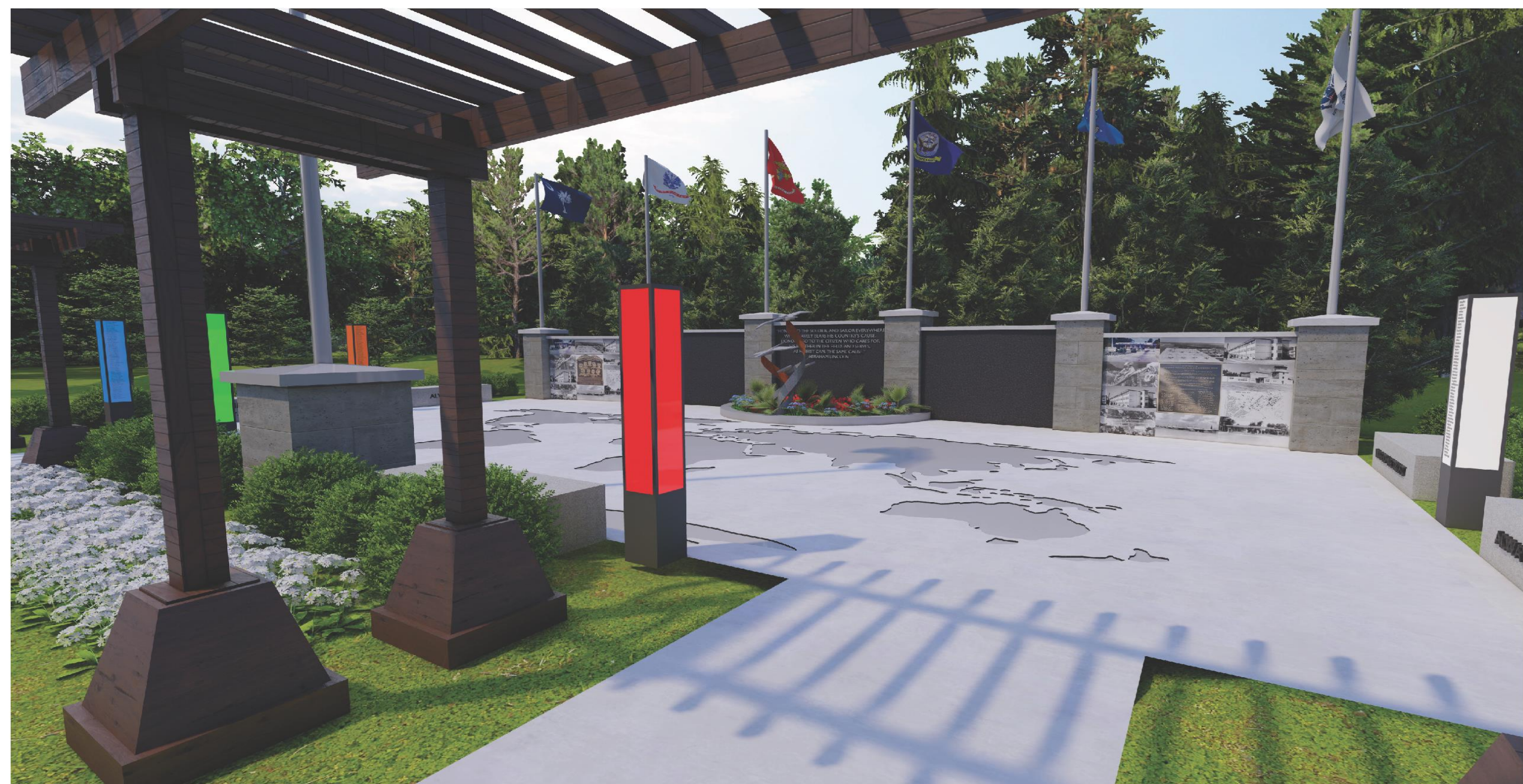





WORLD WAR II MEMORIAL DESIGN PROJECT DATA:

- Overall Memorial Plaza Size: 51'x28' (1,428 Square Feet)
- Memorial Wall Height: 5'-6" to 8'-0"
- Proposed Wall Materials: Wall - Concrete with Black Granite Veneer, Columns – Smooth Stone Veneer
- Plaza Pavement: Decorative Integral Colored Concrete, Donor Brick Pavers, Concrete Inlay.
- Benches: Solid Stone Slabs (2'x6'x18") with Sandblasted Text
- Light Columns: 8' tall internally lit columns with engraved frosted glass.

WORLD WAR II MEMORIAL DESIGN PRELIMINARY COSTS:

Rough Order of Magnitude Cost Estimate below is based on the proposed design as shown within this presentation document.

Estimated Construction Costs: +/- \$615,000

Subtotal Estimate = \$535,000

Mobilization/Demobilization (5%) = \$26,750

Contingency (10%) = \$53,500

*Please note: Project construction cost will be dependent on final design and proposed products and material availability. Preliminary cost estimates will be prepared at the end of the Conceptual Design Phase and for each of the construction document submittals.

ESTIMATED PROJECT SCHEDULE:

	Month 1	Month 2	Month 2	Month 4	Month 5	Month 6	Month 7
PROJECT KICK-OFF MEETING	█						
CONCEPTUAL DESIGN	█						
- STAKEHOLDER/CHARETTE		█	█				
- CONCEPTUAL DESIGN			█				
- PRESENTATION OF FINAL DESIGN				█			
CONSTRUCTION DOCUMENTS							
- 60% SUBMITTAL			█	█			
- CITY REVIEW (1 WEEK)				█			
- 90% SUBMITTAL					█		
- CITY REVIEW (1 WEEK)						█	
- 100% SUBMITTAL							█
- CITY REVIEW (1 WEEK)							█
BIDDING AND NEGOTIATION (45 DAYS)						█	█
CONSTRUCTION OPERATIONS (120 DAYS +)							█

**Please note: Project schedule will be dependent on final design and proposed products and material availability.